

## Manual

DVP050  
DVP100  
DVP170



Visit [www.duratech.be](http://www.duratech.be) for other available languages

30-10-24

**VISION Pro**



## Table of contents

Technical specifications	<b>Page 4</b>
Remarks	<b>Page 5-6</b>
Box contents	<b>Page 7</b>
Installation instructions	<b>Page 10-11</b>
Installation specialties	<b>Page 12-13</b>
Wiring instructions setup 1	<b>Page 14-15</b>
Wiring instructions setup 2	<b>Page 16-17</b>
Wiring remarks	<b>Page 18-19</b>
Synchronizing	<b>Page 20</b>
Color programs	<b>Page 21</b>
Troubleshooting	<b>Page 22</b>

## Technical specifications

Lamp Type	Description	Voltage	Power	Color temp	Luminous flux*
DVP050-RGBW	All colours and Tunable white	10-14 VAC	33 W	n.a.	1200 lm
DVP050-WH	White	10-14 VAC	24 W	5700	2000 lm
DVP100-RGBW	All colours and Tunable white	10-14 VAC	85 W	n.a.	3500 lm
DVP100-WH	White	10-14 VAC	59 W	5700	5500 lm
DVP170-RGBW	All colours and Tunable white	10-14 VAC	180W	n.a.	7000 lm
DVP170-WH	White	10-14 VAC	108W	5700	11000 lm

(\*) Propulsion systems remains a tolerance of +/- 10% on luminous flux measurements @ 25°C ; 12VAC



For operation only with a safety isolation transformer

Minimum input voltage: **10 VAC 50/60 Hz**  
(at lamp terminals)

Nominal input voltage: **12 VAC 50/60 Hz**  
(at lamp terminals)

Maximum input voltage: **14 VAC 50/60 Hz**  
(at lamp terminals)



IEC Protection Class III

Operation on DC voltages is NOT allowed

Maximum water temperature: **+40°C**  
Lamps have to be kept out of ice zones

Ingress protection rate: **IP68**  
measured at 3m max depth = 3m

## Remarks

### Water conditions

Prevent damage to your pool lamps and wires due to unstable water conditions. Your local government may have enacted guidelines for your pool water conditions to apply by. If not we strongly advise the following parameter specifications to be applied:

pH level	6,8 - 7,6
Free Chlorine	max. 3ppm
Combined chlorine	max. 1 ppm
Water temperature	max +40°C and lamps need to be kept out of ice zones

Always adhere to the instructions provided by your chemical brand/supplier for the correct use and application of pool chemicals.

Salt water pools, or pools fitted with a salt water chlorine generator contain salt in the pool water. Salt is a corrosive material. Overdosage and/or consistent levels of salt increase the possibility of deterioration of your pool lamps and cables. As a rule of thumb, a concentration of 35gr/l salt can be accepted when pH values are between 7,2-7,4.

In any case, we urge proper use, care and maintenance of your installation, in order to minimize the effect of corrosion and deterioration.

Please be aware that pool lamps and cables with defects caused due to abnormalities in the water condition are not covered by our factory warranty.

## Installation/maintenance

The luminaire is maintenance free

If the luminaire needs to be replaced, it needs to be completely removed from the water



If the external flexible cable or cord of this luminaire is damaged, it shall be exclusively replaced by the manufacturer or his service agent or a similar qualified person in order to avoid hazard



*VISION Pro Pool lamps must be completely submerged into water during operation. Fixing the lamps with adhesives or silicone kit into a niche is not allowed. Not following these instructions, will void warranty.*

## Box contents

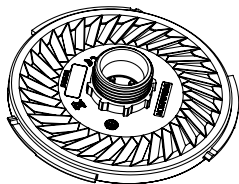

VISION Pro lamp  
(50, 100 or 170 mm)

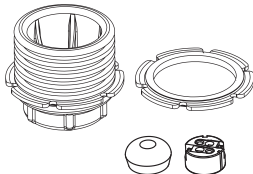

Connection Kit\*

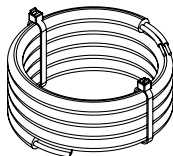

3m Cable\*\*



Manual

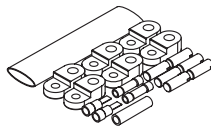

Retrofit Kit  
(only for 170mm models)

* Lamp type	Connection kit	Cable
** DVP050	513-0762 ; 1 washer for fixnut ; blue cable gasket + 1 spare washer	1 mm <sup>2</sup>
DVP100	513-0763 ; 1 washers for fixnut ; orange cable gasket + 1 spare washer	1,5 mm <sup>2</sup>
DVP170	513-0763 ; 1 washers for fixnut; orange cable gasket + 1 spare washer	1,5 mm <sup>2</sup>

## Installation instructions

### Installing faceplate

Toolset \_\_\_\_\_  
( not included )

Contact your local  
distributor for a  
toolset (513-0151)

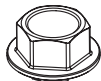
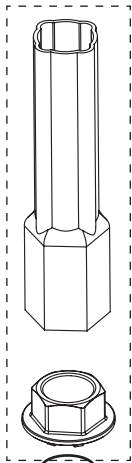

Lamp \_\_\_\_\_

Face Plate \_\_\_\_\_

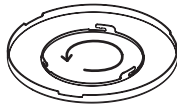



## Installation instructions

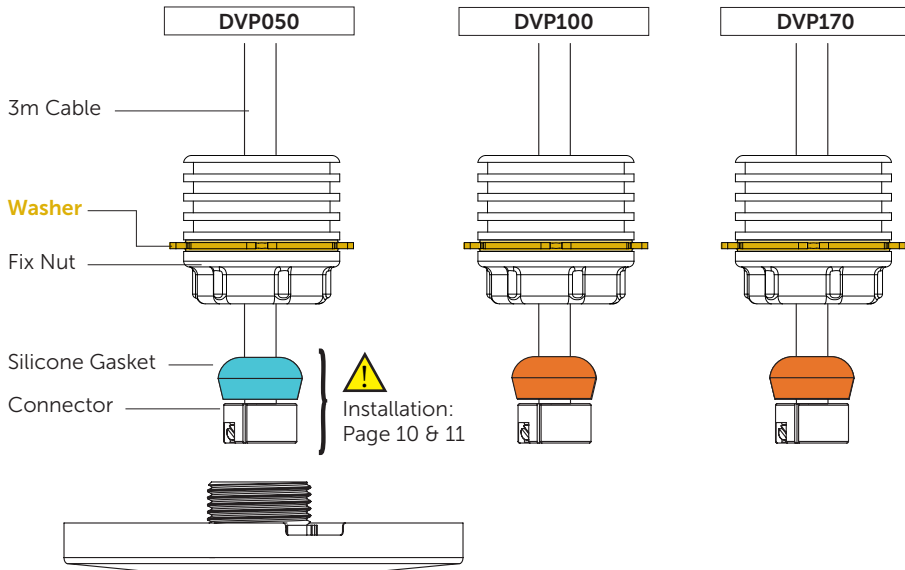

## Connector installation

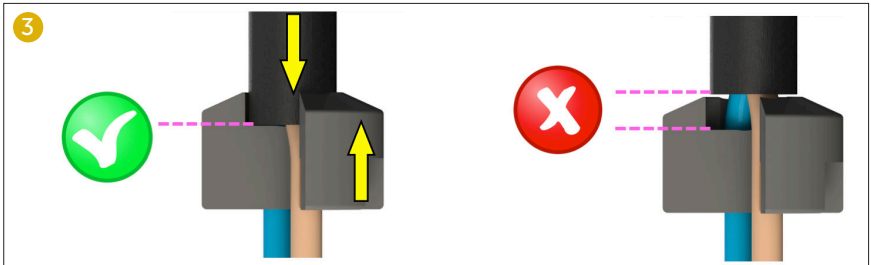
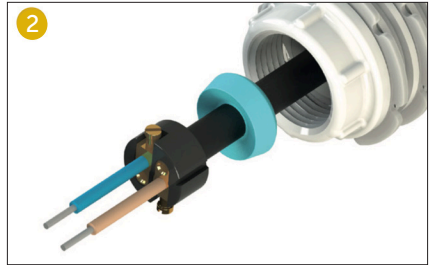
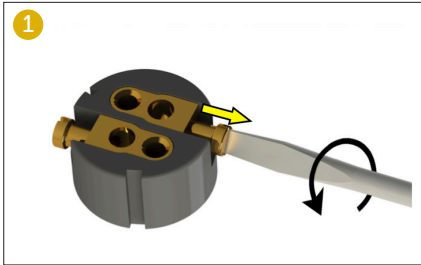



## Installation specialties

### DVP050 & PZA-WG-NG

For installations with DVP050 & PZA-WG-NG:  
Please make sure to only use 1 silicone washer for the Fix nut

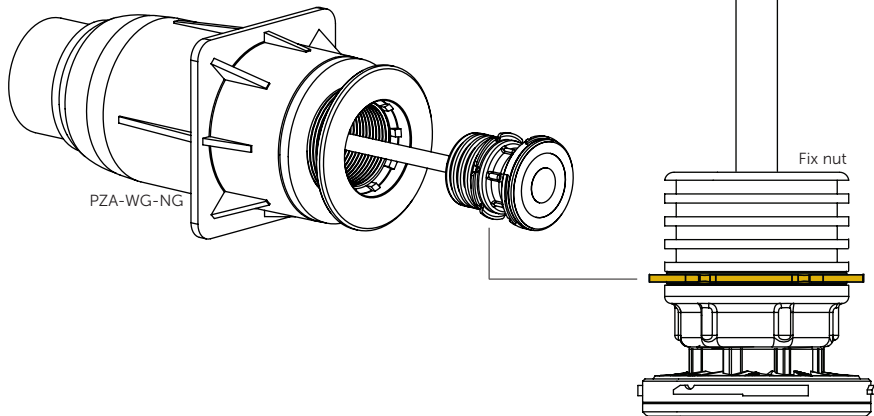

## DVP050 Removal tool

When DVP050 needs to be removed from the PZA-WG wall conduits, a special tool is needed (513-0491)\*

1. Insert the tool over the lamp, straight into the wall conduit
2. Twist the tool counter clockwise the lamp should be snapped into the 3 hooks of the tool
3. Pull the lamp straight out of the wall conduit

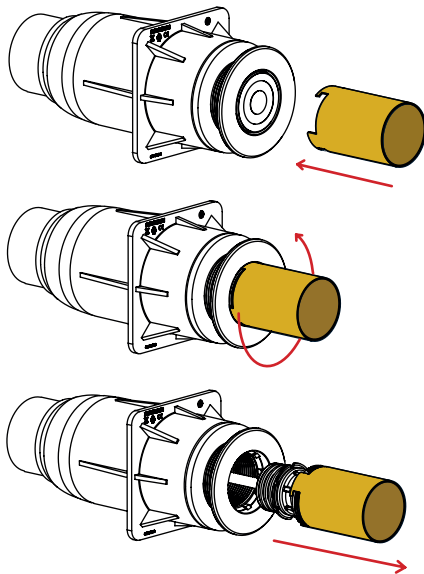

\* Available separately

# Wiring instructions Setup 1

## For new installations



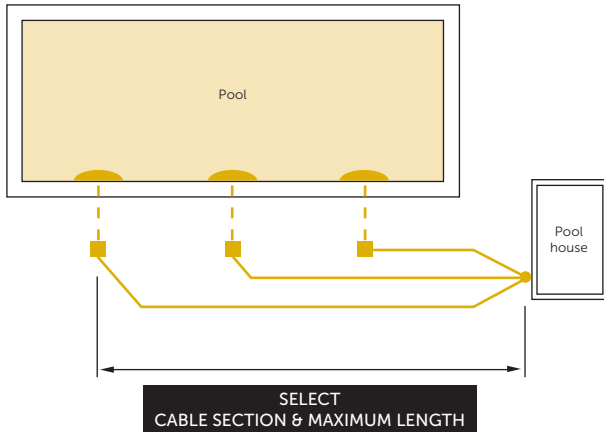





Each lamp is connected to the transformer by a separate cable



- 3m cable included in lamp package
- Separate cable ( not included )



Always use a toroidal transformer

		SELECT CABLE SECTION & MAXIMUM LENGTH (m)					
LAMP TYPE		1,5mm <sup>2</sup>	2,5mm <sup>2</sup>	4,0mm <sup>2</sup>	6,0mm <sup>2</sup>	10mm <sup>2</sup>	VA TRANSFORMER (12VAC)*
	 DVP050-RGBW	30m	59m	86m	156m	229m	28 VA
	 DVP050-WH	36m	71m	104m	187m	275m	29 VA
	 DVP100-RGBW	11m	21m	31m	55m	81m	77 VA
	 DVP100-WH	13m	25m	37m	66m	97m	70 VA
	 DVP170-RGBW	6m	11m	16m	29m	42m	154 VA
	 DVP170-WH	7m	13m	19m	35m	51m	129 VA

**STABLE OPERATION OF THE POOL LIGHTS IS ONLY GUARANTEED WHEN THE INSTALLED CABLE CROSS SECTION MATCHES OR EXCEEDS THE ADVISED VALUES IN THE ABOVE TABLE**

\* The transformer VA rating must be greater or equal to the sum of VA ratings of all connected lamps. These cable lengths are calculated with worst case voltage drops in the electrical wiring.

## Wiring instructions Setup 2

### For existing or other installations

All lamps are connected to the transformer via 1 cable

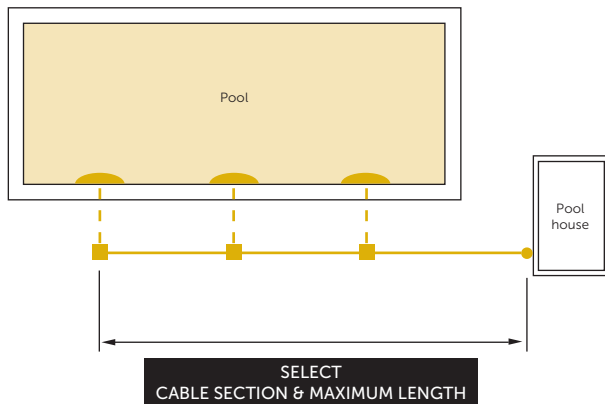









- 3m cable included in lamp package
- Separate cable ( not included )



Always use a toroidal transformer



**SELECT  
CABLE SECTION & MAXIMUM LENGTH (m)**

LAMP TYPE		QTY	1,5mm <sup>2</sup>	2,5mm <sup>2</sup>	4,0mm <sup>2</sup>	6,0mm <sup>2</sup>	10mm <sup>2</sup>	VA TRANSFORMER (12VAC)	
		DVP050-RGBW	1	30	59	86	156	229	28
			2	15	30	43	78	115	56
			3	10	20	29	52	76	84
			4	8	15	22	39	57	112
	DVP050-WH		1	36	71	104	187	275	29
			2	18	36	52	94	138	58
			3	12	24	35	62	92	87
			4	9	18	26	47	69	116
		DVP100-RGBW	1	11	21	31	55	81	77
			2	5	11	16	28	41	154
			3	4	7	10	18	27	231
			4	3	5	8	14	20	308
	DVP100-WH		1	13	25	37	66	97	70
			2	7	13	19	33	49	140
			3	4	8	12	22	32	210
			4	3	6	9	17	24	280
		DVP170-RGBW	1	6	11	16	29	42	154
			2	3	6	8	15	21	308
			3	2	4	5	10	14	462
			4	1	3	4	7	11	616
	DVP170-WH		1	7	13	19	35	51	129
			2	4	7	10	18	26	258
			3	2	4	6	12	17	387
			4	2	3	5	9	13	516

**STABLE OPERATION OF THE POOL LIGHTS IS ONLY GUARANTEED WHEN THE INSTALLED CABLE CROSS SECTION MATCHES OR EXCEEDS THE ADVISED VALUES IN THE ABOVE TABLE**

## Wiring remarks

### For installations with LINK Controller or LINK Master

Third party equipment such as frequency inverters and electric motors can generate excessive noise on the 230VAC / 400VAC power line.

This noise might be injected into the adjacent 12VAC power line and disturb the power line communication towards the VISION Pro RGBW lights.

To prevent this, please take care of the following:



**Keep 230VAC / 400VAC power line cables at least 50cm separated over their full length from the 12VAC power line towards any RGB lights**



**Do not mix 12VAC and 230VAC / 400VAC power line cables into the same cable trays**

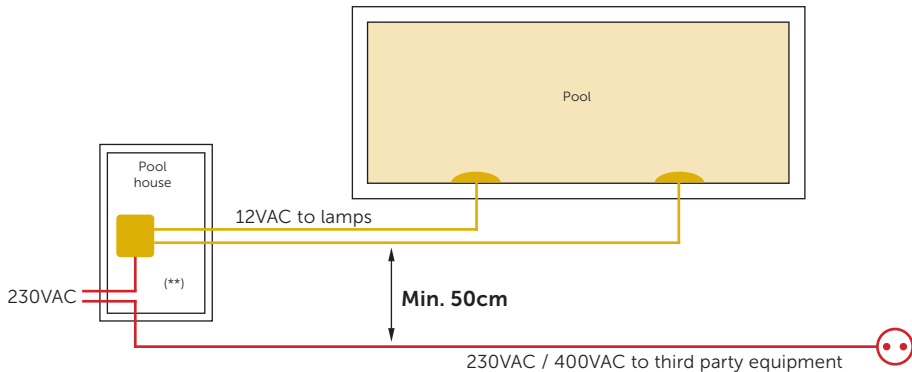

**(\*\*) Do not mix 12VAC and 230VAC / 400VAC power line cables into the same cable trays**

## Synchronizing



### With LinkTouch

- + LINK Controller (PLP-REM or PLP-REM-350)\*
- + LINK Master (DLM450 or DLM600)

First make sure the LinkTouch is paired (see manual LinkTouch)

Turn the lamps on and spin the color wheel on the LinkTouch until the lamps react.

If the lamps do not react, turn them off and back on until they react to the color wheel.

As soon as the lamps follow the color wheel: wait 1 minute. The lamps are now synced.



### With Transmitter

- + LINK Controller (PLP-REM or PLP-REM-350)\*

Turn the lamps on and push the UP button 10 times. Wait for 20 seconds, then turn the lamps off. Repeat this process until the lamps react to the remote. As soon as the lamps follow the remote: wait 1 minute. The lamps are now synced.

### Manual synchronization (without DURALINK control products)

1. Switch ON the 12 VAC line voltage and make sure that all lamps light up.
2. Switch OFF the 12 VAC line voltage and wait for at least 1 minute
3. Switch ON
4. The lamps should now all be on color program 1: Blue

\*PLP-REM or PLP-REM-350 need to have firmware V6.7 (29-07-20) or newer

## Color programs

### RGBW LAMPS

1	DEEP BLUE SEA	Saturated blue
2	DAYLIGHT BLUE	Light blue
3	SUNSET	Slow animation orange - red
4	LOVE IS IN THE AIR	Red
5	FOREST SPRING	Green
6	THINK PINK	Pink
7	SUNSHINE	Yellow
8	JUNGLE BEACH	Slow animation blue & green tints
9	VOODOO	Slow animation red & purple tints
10	DISCO	Fast animation lila-pink-peach-yellow-green blue
11	PARTY	Fast animation blue-green-red-pink-yellow-green
12	WARM WHITE	3000K
13	NEUTRAL WHITE	6000K
14	SUN WHITE	10.500K

- fixed colors
- dynamic colors
- white tints

\*all color programs are dimmable if LINK **Touch**, LINK **Controller** or LINK **Master** are used (in PLC mode)

## Troubleshooting

### PROBLEM

- The pool light is flickering

### SOLUTION

1. Switch the lamps ON and select Cold white color program
2. Remove the lamp from the water, unscrew the fix nut, pull back the gasket and the black cable jacket, so you can reach the brass contacts inside the connector block (do not remove the connector block)
3. Measure the voltage at the lamp terminals (while the lamp is still ON)
4. The voltage at the lamp should be at least 10VAC 50/60Hz.  
If the measured line voltage is below 10VAC:
  - A. Check the output voltage at the transformer terminals.  
This voltage should be between 12VAC and 14VAC.  
Verify that the used transformer VA rating is sufficient for powering all connected lamps
  - B. If the transformer output voltage is ok, then install a thicker cable between the transformer and the lamp.  
(wiring instructions p. 14-19)

- Several pool lights in the pool show different color programs

Make sure that all lamps are connected to the same 12VAC power line. Execute the synchronization as explained on p.20

- The lamp is flashing red

The lamp is exposed to an overvoltage. Consult an electrician to verify the installation and to make sure the voltage at the lamp side is below 14VAC.

## Declaration of Conformity

Declarations of conformity covering this product are available for download from the House of Duratech website: [www.duratech.be](http://www.duratech.be)

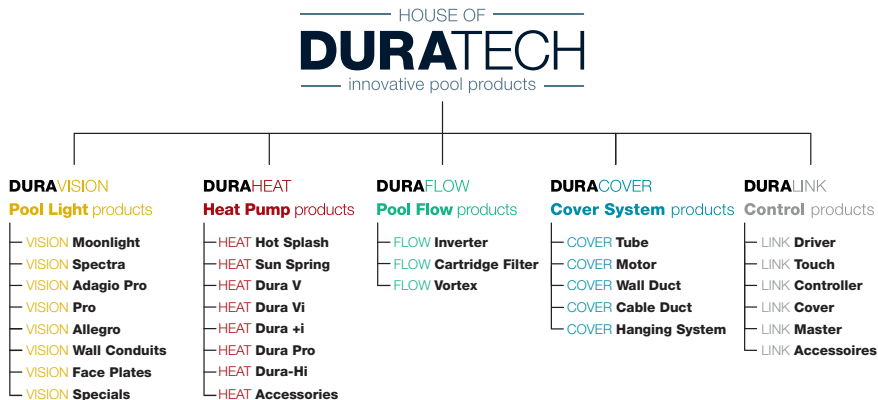

## Contact details

**Propulsion Systems bv**  
Dooren 72  
1785 Merchtem, Belgium

Tel +32 2 461 02 53

[www.duratech.be](http://www.duratech.be)  
[info@propulsionsystems.be](mailto:info@propulsionsystems.be)



**DURAVISION**



We reserve the rights to change all or part of the contents of this document without prior notice